

---

# T50

BUCKLE FOLDING MACHINES

---

## Technical specifications

# MEBO

# EFFICIENCY IN EVERY FOLD



## Meet the T50

The MBO T50 is built to handle a wide range of folding jobs in the 50 x 70 cm half format. Featuring the latest M1 control system, it delivers proven MBO standards like a belt drive system and plug-in slitter shafts, along with optional high-end features typically found in larger models.

Upgrades such as the Vivas vacuum system, slitte shaft cassette, and advanced automation give the T50 flexibility to tackle demanding jobs. Standard features like an intuitive touchscreen and mark-free sheet alignment with high-speed guides ensure precision, productivity, and versatility in one compact package.

## Standard Features & Benefits

- MBO's advanced M1 control system with intuitive touchscreen for easy operation and precise production monitoring
- Vivas vacuum system (Double-Vacubelt and Vacutable) for constant sheet pull and accurate registration
- Slitter shafts with plug-in axles for quick setup and fast changeovers
- High-speed guides in the second folding unit for mark-free sheet alignment and superior output quality
- Optional slitte shaft cassette for fast makeready and ergonomic tooling changes
- Reliable, low-maintenance belt drive system for consistent folding and reduced costs
- Automation options to simplify workflow and minimize setup times

## Versatile Folding. Compact Design. Powerful Output.

### The MBO Advantage

#### Simple to Complex Folds

The T50 handles many fold types, from simple brochures to complex multi-panel layouts. Its flexible setup adapts quickly to varied job needs, perfect for diverse print runs.

#### Space-Saving

Fits tight spaces without losing performance, offering many features of larger folders.

#### Maximized Production Efficiency

Running up to 230 meters per minute, the T50 produces consistent, high-quality folds on long runs. Advanced automation cuts setup time for maximum daily productivity.

## Scan to Learn More

Watch the T50 in action, explore additional features, or request a quote.



T50

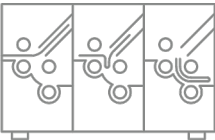

TECHNICAL SPECIFICATIONS		T50 – F (Pile Feeder)		T50 – R (Continuous Feeder)		Folding unit II 50		Knife folding unit X50	
		mm	inch	mm	inch	mm	inch	mm	inch
Pile height	max.	650	25 5/8	-	-	-	-	-	-
Infeed width	min.	150 (105 <sup>1</sup> )	6 (4 1/8 <sup>1</sup> )	150	6	-	-	150	6
	max.	530	20 7/8	530	20 7/8	510	20 1/8	570	22 3/8
Infeed length	min.	150 (105 <sup>1</sup> )	6 (4 1/8 <sup>1</sup> )	180	7	-	-	100	4
	max.	840	33 1/8	840 (1,000)	33 1/8 (40)	-	-	410	16 1/8
Folding length	min.	36	1 3/8	36	1 3/8	36	1 3/8	-	-
Number of buckle plates		4 or 6		4 or 6		4 or 6		-	
Fold roller diameter		39.7	1 1/2	39.7	1 1/2	39.7	1 1/2	40.0	1 1/2
Slitter shaft diameter		30.0	1 1/8	30.0	1 1/8	30.0	1 1/8	30.0	1 1/8
Product thickness at exit (thicker on request)	max.	1.5	1/16	1.5	1/16	1.8	1/16	2.5	1/16
Speed	min.	30 m/min (98 fpm)							
	max.	230 m/min (754 fpm)				205 m/min (670 fpm)		180 m/min (590 fpm)	
Electrical supply	M1 Basic 3 x 400 V 50/60 Hz 3 x 220 V 50/60 Hz	4.7 kVA max. 63 A		4.7 kVA max. 63 A		0.9 kVA max.32 A		0.9 kVA max.32 A	
	M1 Advanced 3 x 400 V 50/60 Hz 3 x 220 V 50/60 Hz	4.7 kVA max. 63 A		4.5 kVA max. 63 A		0.9 kVA max. 32 A		-	

<sup>1</sup> With small format device; for machines without feeder head Vacustar this is the standard minimum format

TECHNICAL DRAWING Floorplan T50 with folding unit II and knife folding unit X50

Measurements: mm  
inch

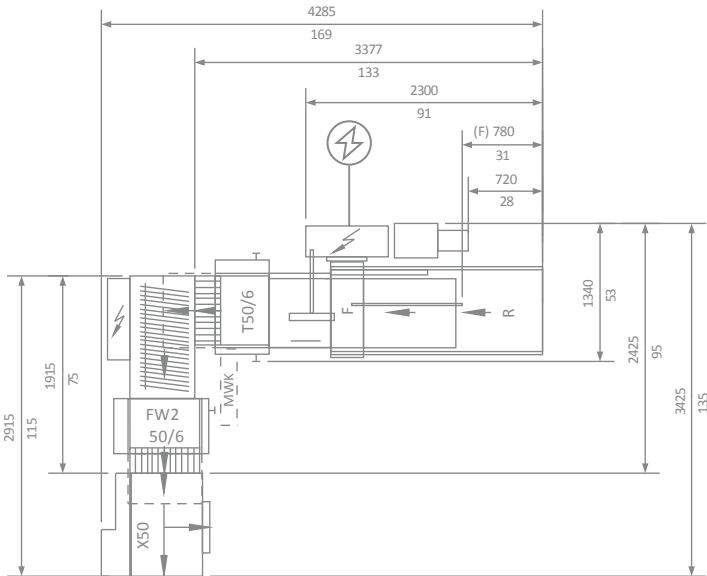

Electrical supply

MBO America  
4 East Stow Road, Suite 12 / Marlton, New Jersey 08053  
Phone 1 609 267 2900  
www.mboamerica.com

For more information, contact your salesman.



SALES@MBOAMERICA.COM