

VT50

Fold Quality Control



The automated folding machine produces on its own and the CoBo-Stack robot sets down the folded signatures. What has been missing up to now for end-to-end automated finishing processes is self-sufficient fold quality control.

The VT50 fold quality control system is unique on the market. Monitoring takes place directly behind the folding machine. Two cameras measure the folding tolerances of the folded sheets. These tolerances can be set by the customer to fit the specific job. Incorrectly folded sheets are ejected from the outlet of the VT50. This ensures that only perfectly folded sheets are transferred to the subsequent delivery system.

The cameras in the MBO VT50 measure the position of the cutting marks relative to the outer edge of the paper.

Your advantages

- Definition of quality tolerances by the operator
- Objective quality control through technology
- Very high process reliability
- Reduction of operator workload



Features

- Machine control M1 Advanced
- Height-adjustable
- 2 cameras for measuring the fold quality
- Waste sheet deflector for incorrectly folded sheets
- A 6 bar compressed air connection must be provided by the customer

Technical specifications

		VT50 Fold Quality Control	
		mm	inch
Infeed width	min.	148	5 3/4
	max.	450	17 3/4
Infeed length	min.	105	4 1/8
	max.	350	13 1/2
Infeed height	min.	340	13 1/4
	max.	850	33 1/2
Speed	max.	150 m/min (492 fpm)	
Output	max.	25,000 sheets/hour	

Floorplan VT50

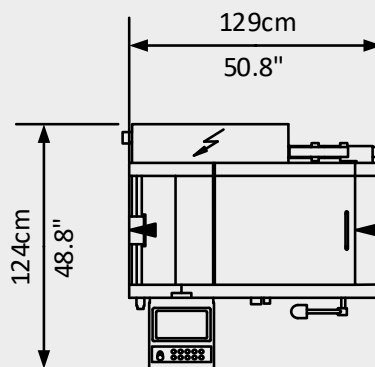

Measurements in $\frac{\text{cm}}{\text{inch}}$

05/2021_v1

MBO Postpress Solutions GmbH
 Grabenstrasse 4-6 ■ 71570 Oppenweiler ■ Germany
 Phone +49 (0) 7191/46-0 ■ info@mbo-pps.com
www.mbo-pps.com

This brochure is subject to change without notice.
 Technical specifications vary depending upon paper quality.

Your contact person: